

Sol-Air® Garden Lights & Sculptures by Advanced PureLiving

Replacing & Disposing of Batteries!

Depending on the model, your product will contain either 1 or 2 AA Ni-Cd or Ni-Mh rechargeable batteries (see Fig. 3) which will generally need to be replaced every 12 months to ensure consistent performance. You may use Ni-Cd or Ni-Mh rechargeable batteries which can be ordered online at: www.advancedpureliving.com

1. Push the power switch to “OFF” position.
2. Unscrew the battery housing.
3. Remove the old battery(ies) and replace it/them with a new AANi-Cd or Ni-Mh rechargeable battery(ies).

The battery mechanism is spring-loaded. Press in the opposite side of the spring and lift out the battery(ies). Reverse this process when installing a new battery(ies).

Preserve our environment by recycling the batteries or dispose of them in accordance with local, state and federal guidelines. **Do NOT** dispose of batteries in the regular trash, municipal waste, streams or by fire as the batteries may leak or explode. **Do NOT** open, mutilate or short-circuit the batteries as this could result in injury.

Product Warranty

- Advanced PureLiving warrants this product to be free from manufacturing and material defects for a period of six (6) months from original date of purchase excluding batteries.
- Warranty is valid only to the original owner with proof of purchase.
- Product abuse, misuse, modification, alteration or opening of the battery will void warranty.

Produced and distributed exclusively by:

 **REAL SPIRIT**
an innovative products group

Real Spirit USA, Inc. • 9447 DeSoto Ave • Chatsworth, CA 91311, U.S.A.
www.AdvancedPureLiving.com • info@AdvancedPureLiving.com
Phone: 888.698.2080 • Fax 818.698.2090

Owner's Manual

Sol-Air®

Illuminated Solar Powered

Garden Lights & Sculptures

by **Advanced PureLiving**
ENVIRO-FRIENDLY TECHNOLOGY

*Totally Solar Powered • Auto-Light at Dusk
No Extension Cords or Electrical Outlets Required*

How Your Solar Garden Product Works

During the day, the solar panel converts sunlight into electricity and recharges the battery(ies) inside the solar panel. At night, the light turns on automatically using the electricity stored during the day. The number of hours the light stays on at night depends on your location and the availability and intensity of sunlight during the day. Under normal conditions, if the solar panel is charged in full, direct sunlight all day, the light should stay lit for several hours at night.

Assembling Your Solar Garden Product

Our solar garden sculptures require little or no assembly and lighted garden stakes (see Fig. 1) assemble quickly in one of two ways:

A) Threadless: Simply insert each rod into the receiving end of the subsequent rod.

B) Threaded: Simply screw each rod clockwise into the next.

If you encounter resistance, separate or unscrew the rods, apply oil or spray lubricant, and try again. Be sure the rods fit snugly but **Do NOT** over tighten. In some case, you may want to insert the lower rod into the ground first and then attach the other rod(s) afterwards. (See *Picking the Right Spot/Inserting Stake Lights* section below.)

Picking the Right Spot/Inserting Stake Lights

Select a garden, lawn or similar location in full, direct sunlight where your solar product can receive at least 6-8 hours of daily sunlight. Shadowed locations will not allow the battery(ies) to charge fully and will reduce the hours of nighttime lighting. **Do NOT** select locations near nighttime light sources such as streetlights, flood lights or other strong outdoor or home lighting, This may cause the solar lights to turn off automatically.

IMPORTANT: To avoid damaging garden stakes when inserting into the ground, select a spot in soft, rock-free, "garden-ready" soil. Insert the base of the stake first then gently insert the rest of the stake into the base. **Do NOT** push directly against the solar cell or the ornament housing containing the actual LED light.

1

Using Your Solar Garden Product the 1st Time

Do **NOT** push the power switch (see Fig. 2) into the "AUTO" position until the solar panel has been charged in direct sunlight for 6-8 hours with the power switch in the "OFF" position. This allows the rechargeable battery(ies) to reach maximum capacity. **If the light does not come on after a full day of charging**, check to be sure the power switch is in the "AUTO" position and that the solar cell is in a bright, sunny spot rather than in the shade.

After fully charging the battery(ies), push the power switch from "OFF" to the "AUTO" position. The light will automatically turn on at dusk and off at dawn.

Tips for Optimal Year 'Round Operation

Your garden lights are sprinkler and rain resistant. However, you should periodically wipe away any dust that may gathered on the solar panel with a damp cloth and keep snow and debris clear of the solar panel. Otherwise the internal battery(ies) may not recharge properly. If the solar panel is covered by dust, snow or other debris for an extended period of time, after cleaning, please allow the battery(ies) to recharge in direct, full sunlight for at least 6-8 hours.

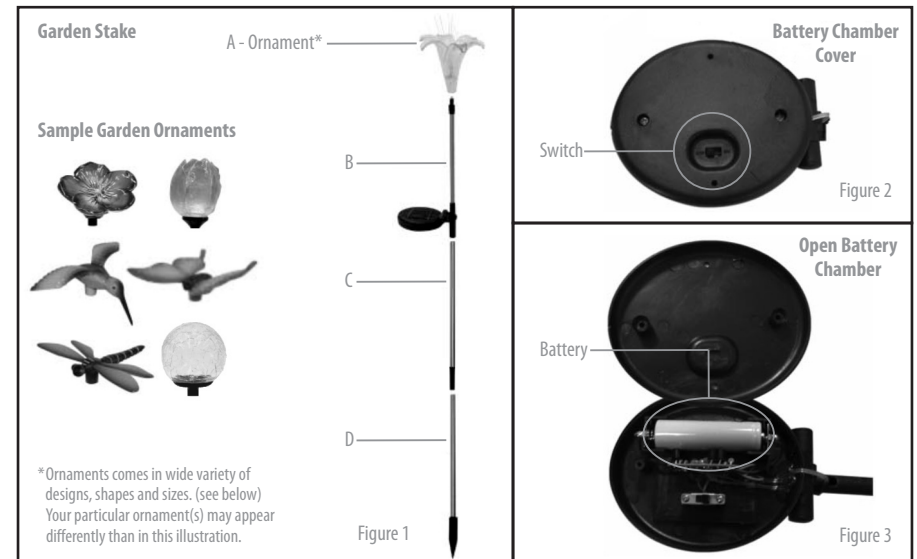

2